

A ⊕

FAST DRY

## MOUNTING INSTRUCTIONS

THIS PRODUCTS IS INTENDED FOR INSTALLATION  
BY A QUALIFIED ELECTRICIAN**Fix this card on the wall.**

⊕ B

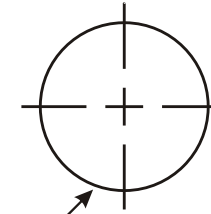
55/64"  
(22 mm)

55/64" (22 mm) FOR SUPPLY CABLE PREFERRED LOCATION

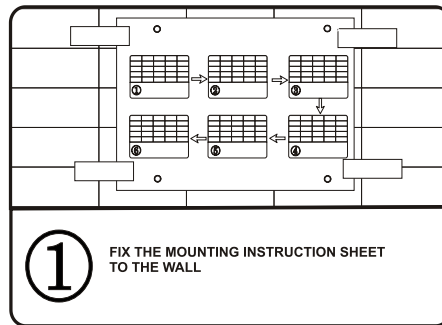

①

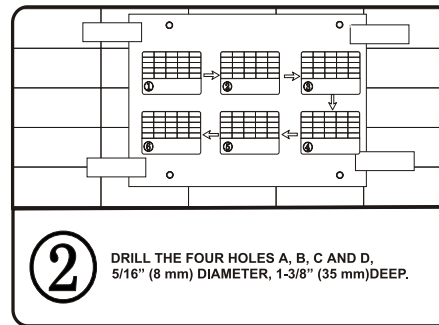
FIX THE MOUNTING INSTRUCTION SHEET  
TO THE WALL

②

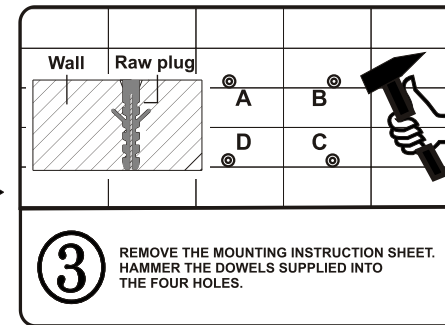
DRILL THE FOUR HOLES A, B, C AND D,  
5/16" (8 mm) DIAMETER, 1-3/8" (35 mm) DEEP.

③

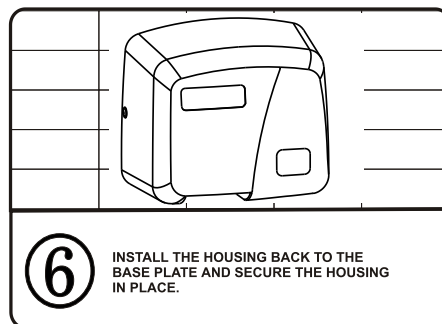
REMOVE THE MOUNTING INSTRUCTION SHEET.  
HAMMER THE DOWELS SUPPLIED INTO  
THE FOUR HOLES.

⑥

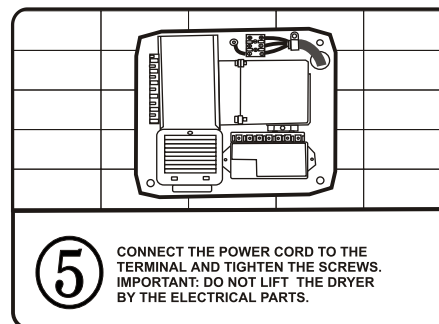
INSTALL THE HOUSING BACK TO THE  
BASE PLATE AND SECURE THE HOUSING  
IN PLACE.

⑤

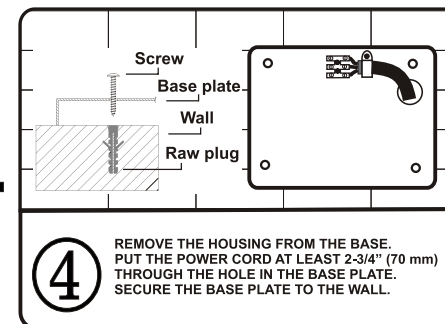
CONNECT THE POWER CORD TO THE  
TERMINAL AND TIGHTEN THE SCREWS.  
IMPORTANT: DO NOT LIFT THE DRYER  
BY THE ELECTRICAL PARTS.

④

REMOVE THE HOUSING FROM THE BASE.  
PUT THE POWER CORD AT LEAST 2-3/4" (70 mm)  
THROUGH THE HOLE IN THE BASE PLATE.  
SECURE THE BASE PLATE TO THE WALL.

D ⊕

50" (127 cm) FROM THE GROUND IS SUITABLE

7-23/32" (196 mm)

⊕ C

6-27/32" (174 mm)